



04

Complesso Storico TORRE DI CAPIATE

This project is a structural analysis of an historic building located in the north of Italy.

The construction of the building began in the Roman period. But, during the Middle Ages, a big part of the original building was destroyed. Until nowadays, the building shape has changed several times.

The consolidation of the building is performed to cover the necessary safety standards of a public building. The owners of the building gave us this project because they want to transform the building into a hostel.

The consolidation is done by projecting connections between the vertical and horizontal elements, avoiding the possibility of collapse of the building.

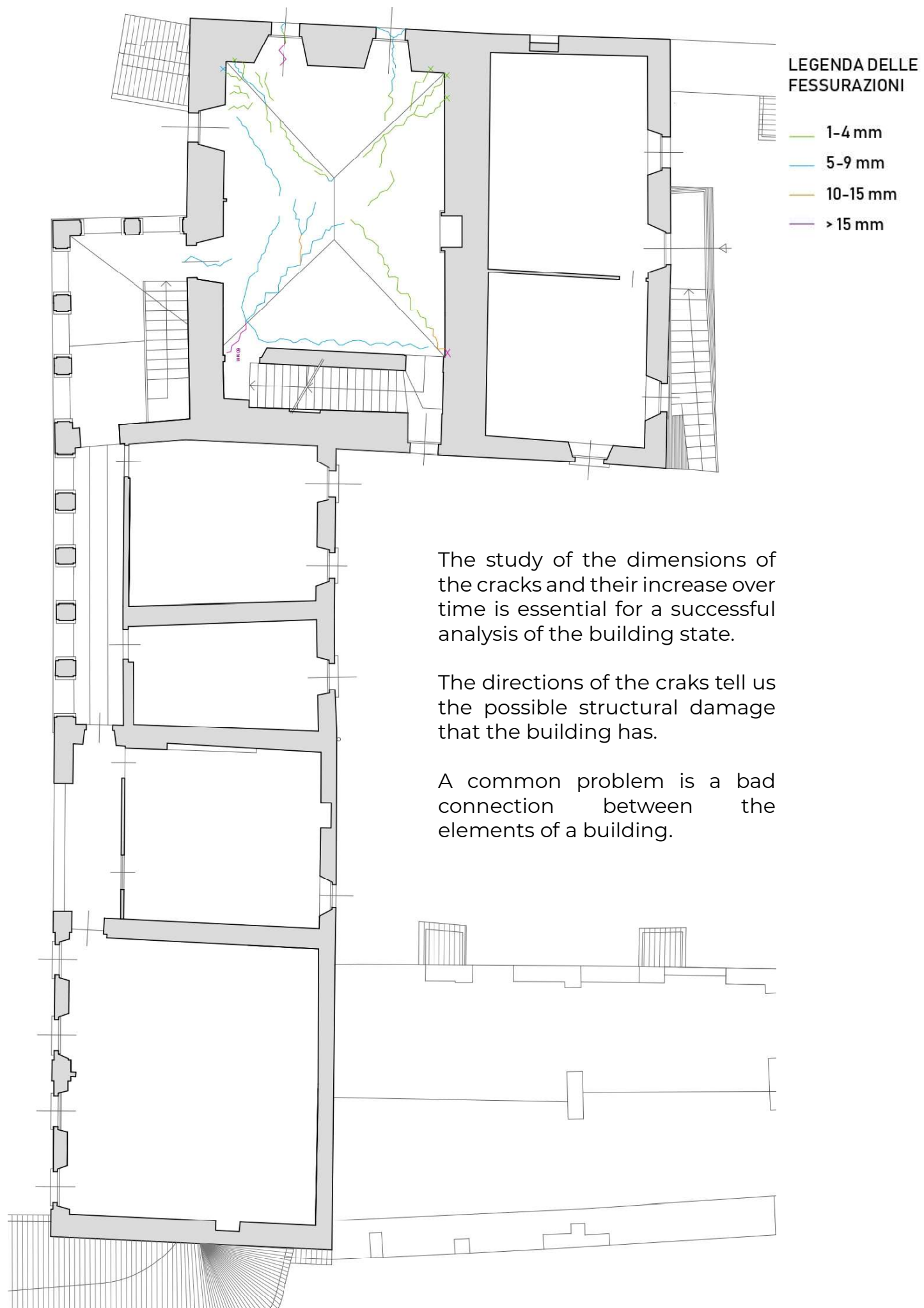

Photographic Registry



CONSOLIDATION PROJECT

The study of finite elements is carried out through the SAP 2000 program.

The building is modeled as accurately as possible. For a correct model it was first necessary to study and draw the surface with all its details and defects.

Historic buildings are characterized by their lack of symmetry. The building ´s shape is a fundamental element to understand its seismic behavior.

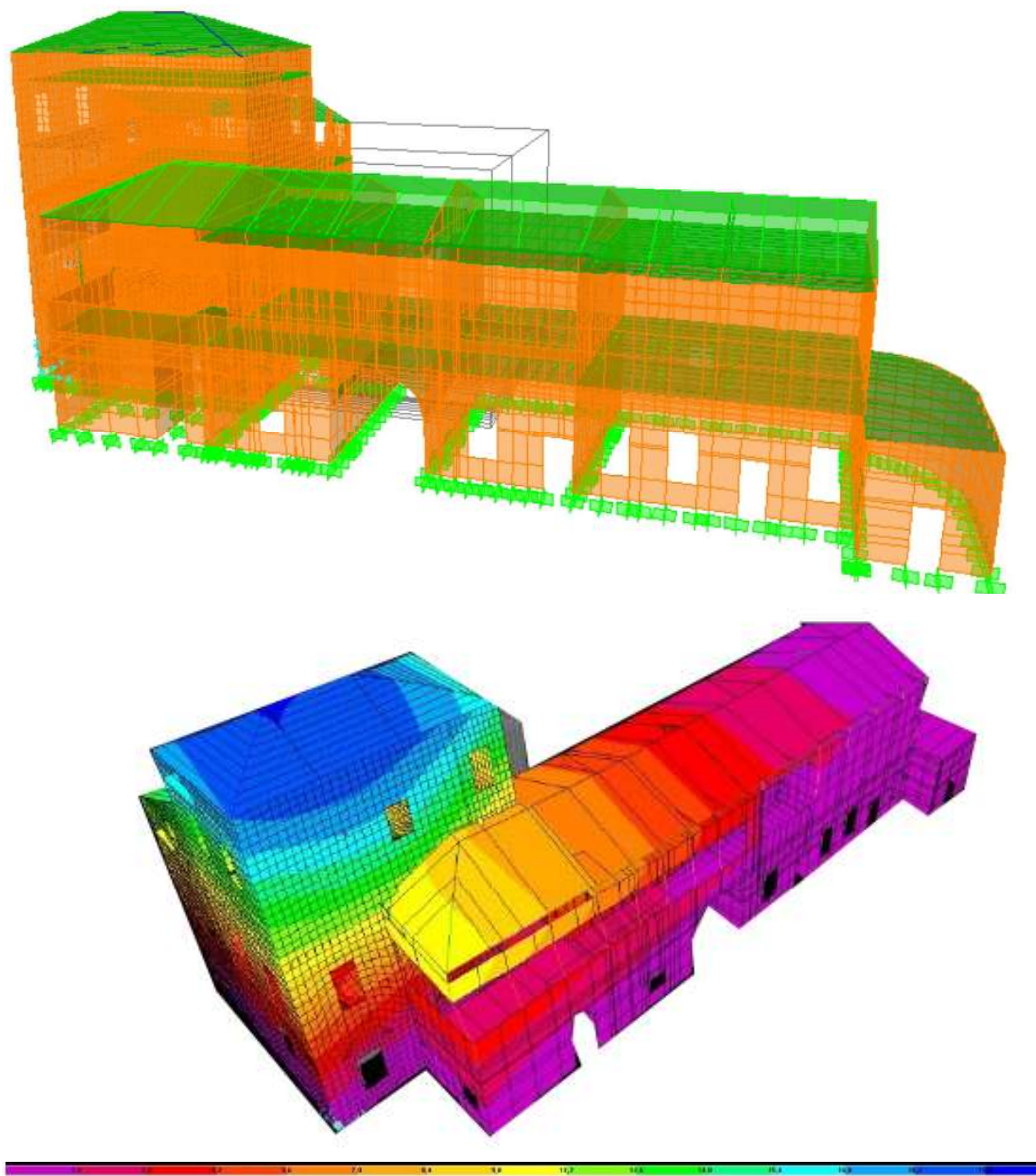

Consolidation Porposal

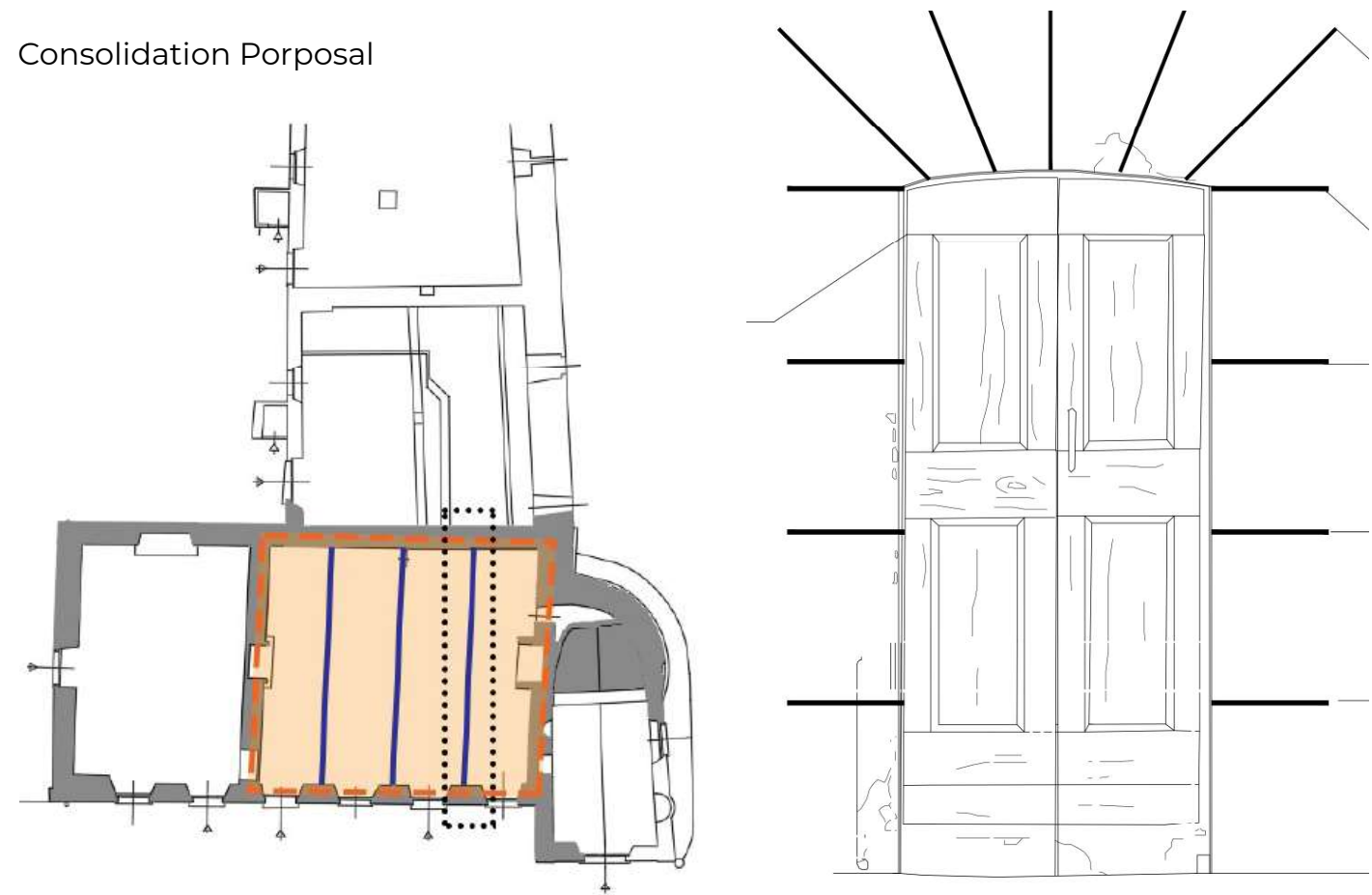

This project proposes to the client a solution where the slab is connected vertically and diagonally to the existing walls and beams. The idea of this consolidation is to make the building a more solid and stable element.

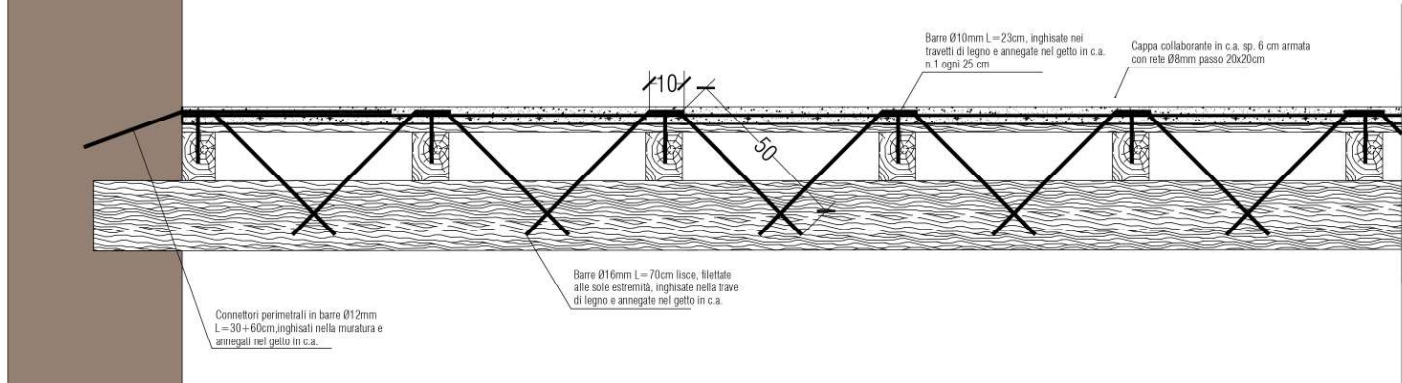

Photographic Registry

